

# Petal Perfect™ with Gemstones Application Instructions.



6.) Clean hands with LeChat Gel Cleanser and Nail Preparation Solution. (Surface must be clean and free of oil and dust)

7.) Gently push back cuticles; remove pterygium.



3.) Remove shine on natural nail bed with LeChat 180 grit Zebra file.

4.) Apply Deco™ tip extensions. Cut and shape according to clients desire. Make sure to blend tips down even to nail bed. Pay close attention to seam line. Brush off access dust with nylon brush. Spray and wipe nails with LeChat Gel Cleanser.

5.) (Optional) if needed, apply LeChat Gel Primer to natural nail bed only. Let dry to chalky-white.

6.) Wet area to lay design, with a thin layer of Gel Base.

7.) Touch the picker with a small amount of Gel Base to pick up LeChat Petal Perfect™ nail art accessories then gently lay petals in desired pattern. (a) Use picker to also pick up gemstones to accent your design.

8.) Cure under UV light for 10 seconds.

9.) Apply Gel Base 1mm from cuticle to entire nail. Be sure to go completely around side walls. Sprinkle LeChat Powder Gel®, making sure to cover both side walls.

10.) Cure for 2 minutes (if necessary after removing from UV light you may apply more Gel Base and Powder Gel® for more leveling or to build a high point then cure again for an additional 2 minutes.) (To maintain clarity of nails, make sure not to use excessive Powder Gel®.)



11.) File and shape nail to ensure even surface. Make sure cuticle area is cleaned and tapered.

12.) Buff entire nail till smooth



13.) Brush off access dust with nylon brush.



14.) Spray and clean nails with LeChat Gel Cleanser and Nail Preparation Solution.

15.) Apply 1 layer of Gel Top, covering all of nail including capping the free edge (do not use excess Gel Top.)



16.) Cure for 10-15 seconds. To ensure smooth surface apply second thin layer of Gel Top then cure for 2 minutes.

17.) Spray and clean nails with LeChat Gel Cleanser and Nail Preparation Solution to wipe off tacky residue.

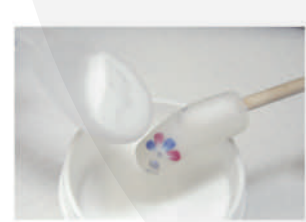
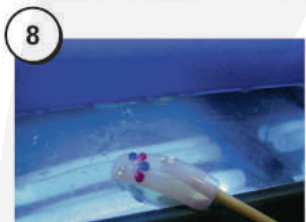

**Final**



## Products Used

